



Lujabetoni

LUJA POLE BASES

LAMP POST BASES

The size of the pole base is determined by the height of the pole entering the base and the diameter of the pole.

LAMP POST BASES

THE POLE IS MOUNTED TO THE BASE USING ADJUSTER BOLTS

BASE TYPE	ELECTRICAL PRODUCT CODE	POLE DIAMETER, mm	POLE HEIGHT, m	RUBBER PROTECTOR	h mm	h1 mm	h2 mm	h3 mm	D1 mm	D2 mm	D3 mm	D4 mm	D5 mm	ADJUSTER BOLTS M16 pcs	CABLE ENTRY SLOT, mm	DL ³	WEIGHT, kg	qty / pallet
RBJ - 2B	4607215	100 - 143	1 - 4	235/xx	700	430	40	50	310	260	155	142	96	3	94	0,06	78	12
RBJ - 2.5B	4607224	100 - 143	1 - 5	235/xx	915	450	50	40	370	260	155	143	109	3	94	0,16	105	6
RBJ - 3B	4607233	100 - 143	1 - 6	235/xx	950	505	60	60	500	300	158	155	101	3	110	0,22	169	4
RBJ - 4B	4607245	100 - 143	4 - 8	235/xx	1300	510	70	65	490	304	158	154	94	3	110	0,66	273	4
RBJ - 4B 4	4607202	100 - 143	4 - 8	235/xx	1300	510	70	65	490	304	158	154	94	4	110	0,66	273	4
RBJ - 4.5B	4607257	128 - 168	6 - 10	235/xx	1250	600	100	60	600	330	188	180	127	4	115	0,64	314	4
RBJ - 4.8B	4607278	128 - 168	8 - 11	235/xx	1500	600	100	60	650	330	188	177	130	4	115	1,25	490	2
RBJ - 5B	4607266	150 - 224	8 - 12	360/xx	1550	680	165	70	600	435	255	250	102	4	115	1,51	515	2
RBJ - 5B 6	4607204	150 - 224	8 - 12	360/xx	1550	680	165	70	600	435	255	250	102	6	115	1,51	515	2
RBJ - 6B	4607287	150 - 224	8 - 15	360/xx	1800	680	110	65	650	435	255	250	137	6	115	2,60	780	2
RBJ - 6/2200B	4607563	150 - 224	8 - 15	360/xx	2200	680	110	65	800	435	255	250	137	6	115	5,40	1100	1
RBJ - 6.3B	4607210	215 - 278	10 - 15	360 430	1870	695	140	65	810	490	310	290	133	6	115	3,47	1100	1
RBJ - 6.5B	4607201	215 - 278	10 - 18	360 430	2000	695	140	65	810	490	310	290	133	8	115	4,35	1250	1

LAMP POST BASES WITH FOUR CABLE ENTRY SLOTS

THE POLE IS MOUNTED TO THE BASE USING ADJUSTER BOLTS

BASE TYPE	ELECTRICAL PRODUCT CODE	POLE DIAMETER, mm	POLE HEIGHT, m	RUBBER PROTECTOR	h mm	h1 mm	h2 mm	h3 mm	D1 mm	D2 mm	D3 mm	D4 mm	D5 mm	ADJUSTER BOLTS M16 pcs	CABLE ENTRY SLOT, mm	DL ³	WEIGHT, kg	qty / pallet
RBJ - 4B 4 / 4KA	4607234	100 - 143	4 - 8	235/xx	1300	510	70	65	490	304	158	154	94	4	110	0,66	273	4
RBJ - 4.5B / 4KA	4607235	128 - 168	6 - 10	235/xx	1250	600	100	60	600	330	188	180	127	4	115	0,64	314	4
RBJ - 4.8B / 4KA	4607238	128 - 168	8 - 11	235/xx	1500	600	100	60	650	330	188	177	130	4	115	1,25	490	2
RBJ - 5B 6 / 4KA	4607231	150 - 224	8 - 12	360/xx	1550	680	165	70	600	435	255	250	102	6	115	1,51	515	2
RBJ - 6B / 4KA	4607241	150 - 224	8 - 15	360/xx	1800	680	110	65	650	435	255	250	137	6	115	2,60	780	2
RBJ - 6.3B / 4KA	4607243	215 - 278	10 - 15	360 430	1870	695	140	65	810	490	310	290	133	6	115	3,47	1100	1

BASES WITH STEEL COLLARS

THE POLE IS MOUNTED TO THE BASE USING ADJUSTER BOLTS

BASE TYPE	ELECTRICAL PRODUCT CODE	POLE DIAMETER, mm	POLE HEIGHT, m	RUBBER PROTECTOR	h mm	h1 mm	h2 mm	h3 mm	D1 mm	D2 mm	D3 mm	D4 mm	D5 mm	ADJUSTER BOLTS M16 pcs	CABLE ENTRY SLOT, mm	DL ³	WEIGHT, kg	qty / pallet
RBJ - 3 RST	4607207	100 - 143	1 - 6	235/xx	950	505	60	60	500	300	158	155	101	3	94	0,21	169	4
RBJ - 4 RST	4607208	100 - 143	4 - 8	235/xx	1300	510	70	65	490	304	158	154	94	3	110	0,67	273	4
RBJ - 4.5 RST	4607217	128 - 168	6 - 10	235/xx	1250	600	100	60	600	330	188	180	127	4	115	0,61	314	4
RBJ - 4.8 RST	4607219	128 - 168	8 - 11	235/xx	1500	600	100	60	650	330	188	177	130	4	115	1,10	490	2
RBJ - 5 RST	4607220	150 - 224	8 - 12	360/xx	1500	660	165	70	600	420	240	228	102	6	115	1,35	500	2
RBJ - 6 RST	4607222	150 - 224	8 - 15	360/xx	1800	680	110	65	650	420	255	250	137	6	115	2,60	780	2

BASES WITH STEEL COLLARS AND FOUR CABLE ENTRY SLOTS

THE POLE IS MOUNTED TO THE BASE USING ADJUSTER BOLTS

BASE TYPE	ELECTRICAL PRODUCT CODE	POLE DIAMETER, mm	POLE HEIGHT, m	RUBBER PROTECTOR	h mm	h1 mm	h2 mm	h3 mm	D1 mm	D2 mm	D3 mm	D4 mm	D5 mm	ADJUSTER BOLTS M16 pcs	CABLE ENTRY SLOT, mm	DL ³	WEIGHT, kg	qty / pallet
RBJ - 4 RST / 4KA	4607228	100 - 143	4 - 8	235/xx	1300	510	70	65	490	304	158	154	94	3	110	0,67	273	4
RBJ - 4.5 RST / 4KA	4607237	128 - 168	6 - 10	235/xx	1250	600	100	60	600	330	188	180	127	4	115	0,61	314	4
RBJ - 4.8 RST / 4KA	4607229	128 - 168	8 - 11	235/xx	1500	600	100	60	650	330	188	177	130	4	115	1,10	490	2
RBJ - 5 RST / 4KA	4607240	150 - 224	8 - 12	360/xx	1500	660	165	70	600	420	240	228	102	6	115	1,35	500	2
RBJ - 6 RST / 4KA	4607232	150 - 224	8 - 15	360/xx	1800	680	110	65	650	420	255	250	137	6	115	2,60	780	2

BASES FOR WOODEN POLES

THE POLE IS MOUNTED TO THE BASE USING ADJUSTER BOLTS

BASE TYPE	ELECTRICAL PRODUCT CODE	POLE DIAMETER, mm	POLE HEIGHT, m	RUBBER PROTECTOR	h mm	h1 mm	h2 mm	h3 mm	D1 mm	D2 mm	D3 mm	D4 mm	D5 mm	ADJUSTER BOLTS M16 pcs	CABLE ENTRY SLOT, mm	DL3	WEIGHT, kg	qty / pal-let
RBJ - 5 PP	4607225	150 - 224	8 - 9	360/xx	1550	680	165	70	600	435	255	250	102	6	115	1,52	515	2
RBJ - 6 PP	4607223	150 - 224	10 - 11	360/xx	1800	680	110	65	650	435	255	250	137	6	115	2,60	780	2
RBJ - 6.3 PP	4607226	215 - 278	12 - 13	360 430	1870	695	140	65	810	490	310	290	133	6	115	3,47	1100	1

BASES WITH PLATES

THE POLE IS MOUNTED TO THE BASE USING ADJUSTER BOLTS, FINAL MOUNTING OF POLE REQUIRES GROUTING

BASE TYPE	ELECTRICAL PRODUCT CODE	POLE DIAMETER, mm	POLE HEIGHT, m	h mm	h1 mm	h2 mm	h3 mm	D1 mm	D2 mm	D3 mm	D4 mm	D5 mm	ADJUSTER BOLTS M16 pcs	CABLE ENTRY SLOT, mm	DL3	WEIGHT, kg
RBJ - 7C	4607323	250 - 360	10 - 15	2000	920	180	70	600	600	382	380	95	8	115	4,12	1080
RBJ - 7/2400C	4607326	250 - 360	15 - 20	2400	920	180	70	600	600	382	380	95	8	115	7,54	1500

BASES WITH PLATES

THE POLE IS MOUNTED TO THE BASE USING ADJUSTER BOLTS, *FINAL MOUNTING OF POLE REQUIRES GROUTING

BASE TYPE	ELECTRICAL PRODUCT CODE	POLE DIAMETER, mm	POLE HEIGHT, m	RUBBER PROTECTOR	h mm	h1 mm	h2 mm	h3 mm	PLATE, mm	D2 mm	D3 mm	D4 mm	D5 mm	ADJUSTER BOLTS M16 pcs	CABLE ENTRY SLOT, mm	WEIGHT, kg
RBJ - 6L	4607308	150 - 224	10 - 15	360/xx	1290	660	165	70	1800 x 1800 x 250	420	240	228	102	6	115	2175
RBJ - 6.5L	4607211	215 - 278	10 - 18	360 430	1450	695	140	65	1800 x 1800 x 250	500	310	290	133	8	115	2380
RBJ - 7L *	4607329	250 - 360	15 - 20		1600	920	180	70	1800 x 1800 x 250	600	382	380	95	8	115	2500

DIMENSIONS

Dimensional tolerances:
 - height ± 30 mm
 - other dimensions ± 5 mm

We reserve the right to make changes to the technical details

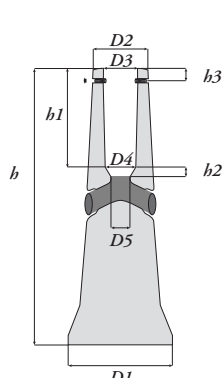

BASE FOR LAMP POLES mounting using adjuster bolts, bases with steel collars

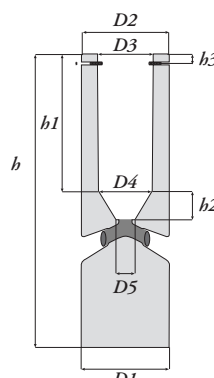

LIGHT MAST BASE mounting using adjuster bolts

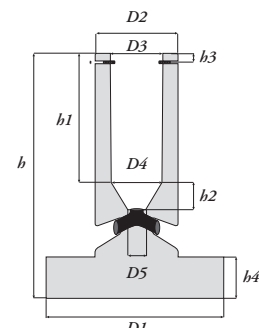

BASE WITH PLATE mounting using adjuster bolts

RUBBER PROTECTORS

TYPE	ELECTRICAL PRODUCT CODE	POLE DIAMETER, mm	FOR BASES	pcs / box
88,9 mm	4607594	88,9	RBJ - 2.8D, RBJ - 4F	100
235/95K	4607383	100 - 110	RBJ - 2 - RBJ - 4.8	100
235/103K	4607386	111 - 120	RBJ - 2 - RBJ - 4.8	100
235/113K	4607389	121 - 134	RBJ - 2 - RBJ - 4.8	100
235/126K	4607392	135 - 143	RBJ - 2 - RBJ - 4.8	100
235/145K	4607395	150 - 168	RBJ - 4.5 - RBJ - 4.8	100
360/149K	4607216	155 - 175	RBJ - 5 - RBJ - 6	25
360/170K	4607403	176 - 192	RBJ - 5 - RBJ - 6	25
360/187K	4607405	193 - 209	RBJ - 5 - RBJ - 6	25
360/204K	4607407	210 - 224	RBJ - 5 - RBJ - 6.5	25
430/230K	4607205	238 - 253	RBJ - 6.3 - RBJ - 6.5	25
430/250K	4607214	254 - 273	RBJ - 6.3 - RBJ - 6.5	25



LAMP POST BASES

THE POLE IS MOUNTED TO THE BASE USING WOODEN WEDGES.

BASE TYPE	ELECTRICAL PRODUCT CODE	POLE DIAMETER, mm	POLE HEIGHT, m	RUBBER PROTECTOR	WOODEN WEDGES	h mm	h1 mm	h2 mm	D1 mm	D2 mm	D3 mm	D4 mm	D5 mm	DL ³	CABLE ENTRY SLOT, mm	WEIGHT, kg	qty / pallet
RBJ - 2A	4607212	100 - 143	1 - 4	235/xx		700	430	40	310	260	155	142	96	0,06	94	78	12
RBJ - 2.5A	4607221	100 - 143	1 - 5	235/xx		915	450	50	370	260	155	143	109	0,17	94	105	6
RBJ - 3A	4607230	100 - 143	1 - 6	235/xx		950	505	60	500	300	158	155	101	0,21	94	169	4
RJB - 4A	4607242	100 - 143	4 - 8	235/xx		1300	510	70	490	304	158	154	94	0,67	110	273	4
RBJ - 4.5A	4607254	128 - 168	6 - 10	235/xx		1250	600	100	600	330	188	180	127	0,61	115	314	4
RBJ - 5A	4607263	150 - 224	8 - 12	360/xx		1500	660	165	600	420	240	228	102	1,35	115	500	2

WOODEN WEDGES

TYPE	ELECTRICAL PRODUCT CODE	IN SET, pcs	FOR BASES
for 30 - 50 mm poles	4607341	3	RBJ - A1, A2 and A3
for 100 - 143 mm poles	4607344	4	RBJ - 2A, 2.5A, 3A and 4A
for 150 - 224 mm poles	4607347	4	RBJ - 4.5A and 5A

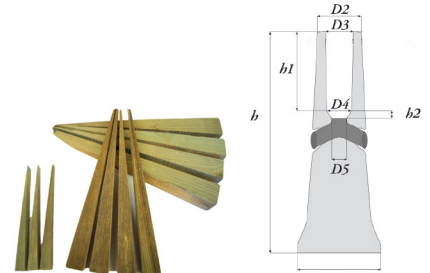

BASES RBJ - 2A - 5A plastic locking ring or wooden wedges

BASES FOR TRAFFIC SIGNS, GUIDE MAPS, OUTDOOR LIGHTS AND CAR HEATING POLES

THE POLE IS MOUNTED TO THE BASE USING A PLASTIC LOCKING RING.

BASE TYPE	ELECTRICAL PRODUCT CODE	POLE DIAMETER, mm	POLE HEIGHT, m	PLASTIC LOCKING RING	RUBBER PROTECTOR	h mm	h1 mm	D1 mm	D2 mm	D3 mm	DL ³	CABLE ENTRY SLOT, mm D6	WEIGHT, kg	qty / pallet
RBJ - A1	4607200	38 - 50, 60,3	1 - 3	38-50 60,3		480	430	210	142	82		45x25	21	40
RBJ - A2	4607203	38 - 50, 60,3	1 - 3	38-50 60,3		680	630	210	142	82		50x35	29	30
RBJ - A3	4607206	38 - 50, 60,3	1 - 5	38-50 60,3		900	630	250	142	82		20	53	15
RBJ - 2A	4607212	114	1 - 4	114	235/103K	700	470 - 510	310	262	156	0,06	94	78	12
RBJ - 2.5A	4607221	114	1 - 5	114	235/103K	915	450	370	260	155	0,16	94	105	6
RBJ - 2.8D	4607528	88,9	1 - 5	88,9	88,9	915	510	370	260	130	0,16	94	115	6
RBJ - 4A	4607242	114	4 - 8	114	235/103K	1300	500 - 550	490	304	158	0,66	110	273	4
RBJ - 4F	4607252	88,9	4 - 8	88,9	88,9	1300	500 - 550	490	302	129	0,66	110	292	4

Rubber protectors are listed on page 3.

PLASTIC LOCKING RINGS

TYPE	ELECTRICAL PRODUCT CODE	FOR BASES
for 38 - 50 mm poles	4607332	RBJ - A1, A2 and A3
for 60,3 mm poles	4607335	RBJ - A1, A2 and A3
for 88,9 mm poles	4607593	RBJ - 2.8D and 4F
for 114 mm poles	4607338	RBJ - 2A, 2.5A, 3A and 4A

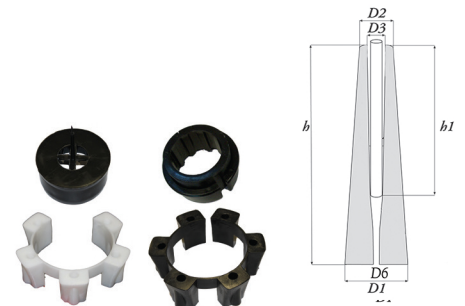

BASES RBJ - A1 - A3 plastic locking ring or wooden wedges

FOUNDATIONS, LOCATION AND HEIGHT OF THE BASE

The filling around the base must be packed in 0.5 m layers by tamping with a wooden pole or similar tool attached to an excavator bucket, or in 0.3 m layers using a vibrating plate.

The bases are mounted upright, in the location and at the height specified in the planning documents. Before the mounting of the pole, the location of the base must be verified through control measurements during mounting work.

For road lighting, the bases must be installed at a height of 50-150 mm from ground level. The installation height of bases for flexible poles is 50-100 mm. *InfraRYL 2006: General quality requirements for infrastructure construction. Part 2: Systems and supplementary components. (in Finnish)*

POLE BASES FOR FLANGED POLES

The bases are also available with plates; the standard plate size is 1800 x 1800 x 250 mm

TYPE	RBJ-7/flange	RBJ-9/flange
FLANGE	1, 2, 3, 4, 5, 6 or 7	8 or 9
BASE LENGTH, mm	2000 or 2400	2000 or 2500
BASE WEIGHT, kg	1130 or 1430	3400 or 4250
BASE DIAMETER mm	600	950

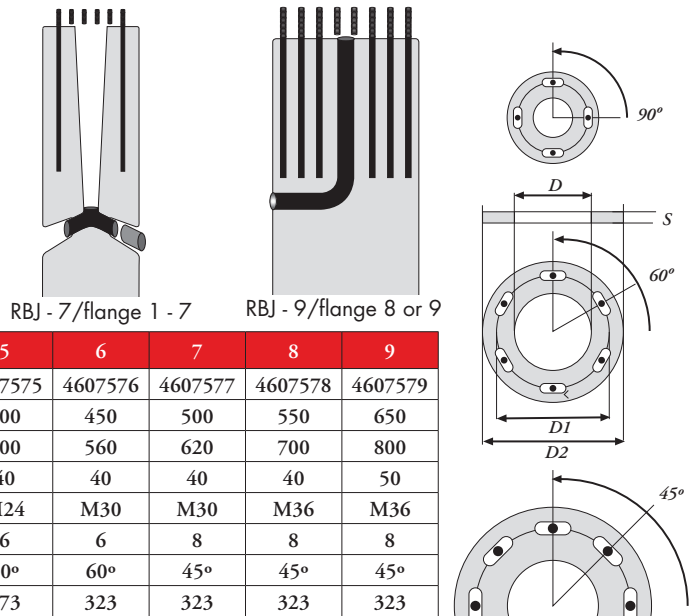

FLANGE	1	2	3	4	5	6	7	8	9
ELECTRICAL PDT CODE	4607571	4607572	4607573	4607574	4607575	4607576	4607577	4607578	4607579
D1	200	250	325	325	400	450	500	550	650
D2	260	325	420	420	500	560	620	700	800
S	20	25	25	32	40	40	40	40	50
SCREW	M16	M20	M24	M24	M24	M30	M30	M36	M36
NUMBER OF SCREWS	4	4	4	4	6	6	8	8	8
K	90°	90°	90°	90°	60°	60°	45°	45°	45°
D	108	140	168	219	273	323	323	323	323

INSTALLATION INSTRUCTIONS

POLE MOUNTING WITH ADJUSTER BOLTS

1. Thread the rubber protector onto the pole.
2. Lower the pole into the base (as deep as it will go).
3. Remove the plastic dust caps from the adjuster screws on the base, e.g. with the tip of a screwdriver.
4. Make sure the pole is straight.
5. Tighten the adjuster screws with an 8 mm Allen key. Do not tighten too much so that the pole will not dent.
6. Replace the dust caps of the screws.
7. Push the rubber protector into place.

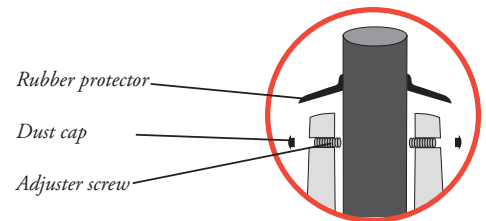

POLE MOUNTING WITH WOODEN WEDGES

1. Thread the rubber protector onto the pole.
2. Lower the pole into the base (as deep as it will go).
3. Make sure the pole is straight.
4. Drive the wooden wedges between the pole and base from opposite sides.
5. Cut off the part of the wedge that protrudes above the base.
6. The service life of the durable wood of the wedges is approximately 25 years.
7. For poles that will be in use for a longer period, we recommend filling the gaps between the wedges with concrete filler or sand.
8. Push the rubber protector into place.

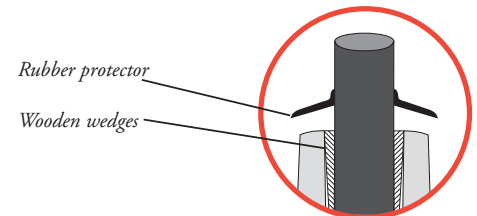

POLE MOUNTED WITH PLASTIC LOCKING RING

BASES RBJ - A1, A2 AND A3

1. Thread the plastic locking rings onto the pole.
2. Slam the pole into the base and it will lock into the rectangular bottom.
3. Push the locking rings between the base and pole.

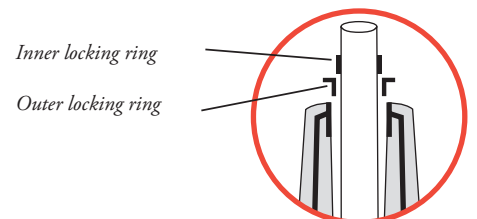

POLE MOUNTED WITH PLASTIC LOCKING RING

BASES RBJ - 2.8D, 4F, 2.5A, 3A AND 4A

1. Thread the rubber protector onto the pole.
2. Thread the plastic locking rings onto the pole.
3. Lower the pole into the base (as deep as it will go).
4. Push the locking ring between the base and pole.
5. Lower the rubber protector to rest against the base.

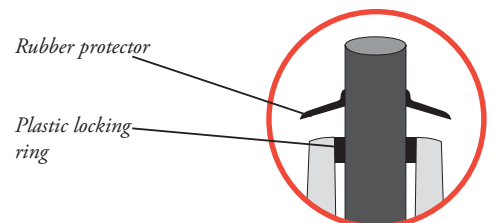

FOR LIGHT MAST BASES RBJ - 7C AND RBJ - 7/2400C

Straighten the mast with the adjuster bolts and immediately fill the gap between the mast and base with concrete filler. The mast must not be left to rest on the bolts alone.

Lujabetoni

LUJABETONI POLE BASES

Lujabetoni has been producing pole bases since 1991. In the design of the bases, particular attention has been paid to the adjustability of the pole, strength of the upper part of the base, and the shape of the cable entry slot.

TECHNICAL SPECIFICATIONS

- Base concrete C32/40 XF4
- Reinforcement B500A and B500B
- Adjuster parts stainless steel
- Steel collars stainless steel
- The rubber protectors are made of a TP elastomer with excellent weather resistance.
- The 10-metre safety pole of Tehomet Oy has been impact-tested with an RBJ - 5B 6 base and the 12-metre HE safety pole with an RBJ - 6B base.

Our systems have been certified in three areas: the quality management system according to standard ISO 9001:2015, environmental management system according to standard ISO 14001:2015 and occupational health and safety management system according to standard ISO 45001:2018.



**IN ALL CONCRETE CONSTRUCTION
CONTACT THE STRONGEST CONCRETE EXPERT!**

ORDERS: betonituotetilaukset@lujja.fi

| WWW.LUJABETONI.FI

Vieremä factory

+ 358 20 789 5670